

AIR-COOLED TIG WELDING TORCH CT-26F-E

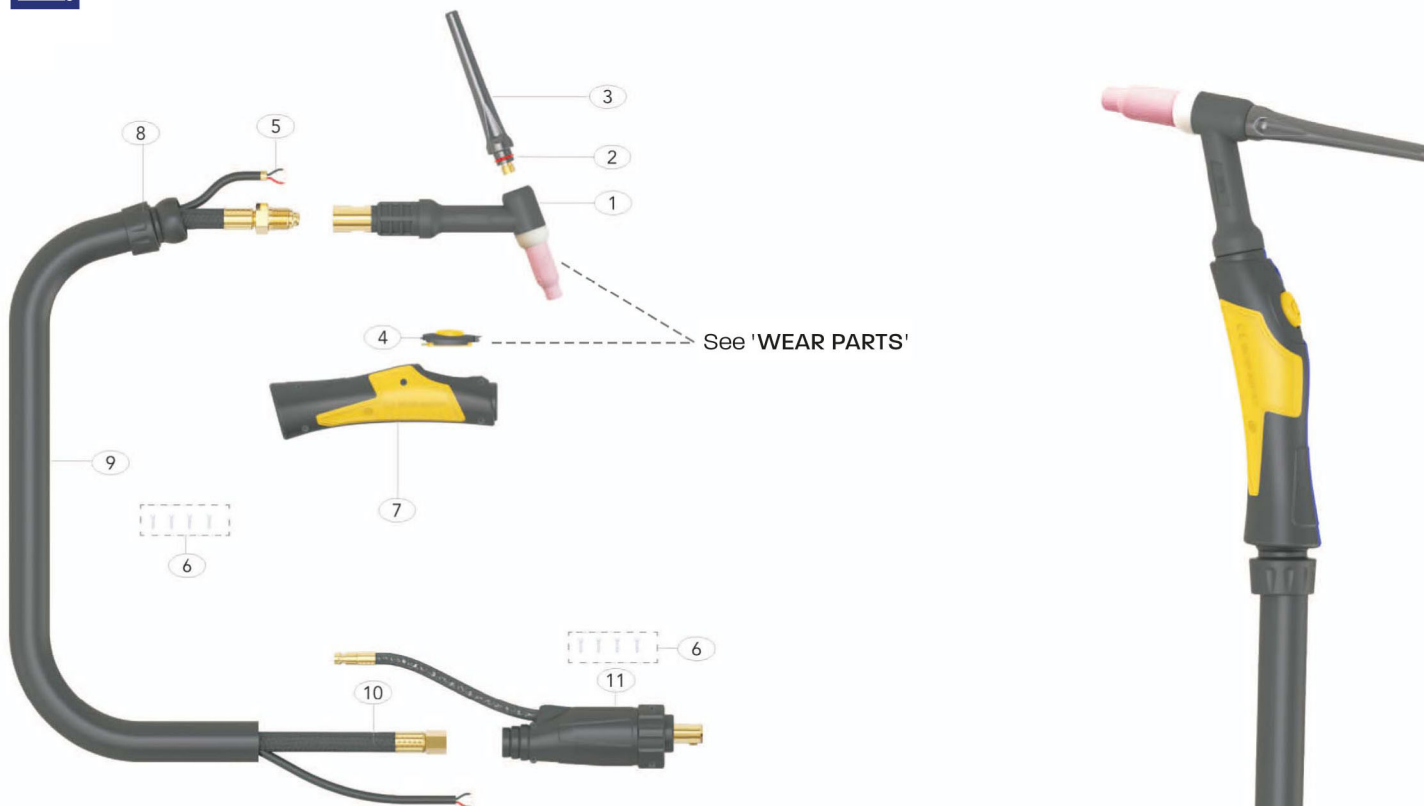

Rating: 180A DC 125A AC @ 35% duty cycle



Model	Part Number	
Description	12ft	25ft
CT-26 F TIG TORCH	CWCAN-SG26FX-S1-12SLGS4	CWCAN-SG26FX-S1-25SLGS4

Spare parts			
Part Number	Description		
1 CWWP26FX	Torch Body Flexible	8 CWPT-ERKJ200	Large Knuckle Joint
2 CW98W18	Back Cap 'O' Ring	9 CWPL200-40	Neoprene Cover Assembly X 4m
3 CW57Y02	Back Cap Long	CWPL200-80	Neoprene Cover Assembly X 8m
4 CWEK-ER1MS-BF	ECE Momentary Kit	10 CWPGD46V28OB-EPC2	Power Cable×4m O/B Rubber
5 CW3100224216-4.2	Switch Wire 4m	CWPGD46V30OB-EPC2	Power Cable×8m O/B Rubber
CW3100224216-7.7	Switch Wire 8m	11 CWML3550-M12-L-G7	Power Adaptor 8.9mm QF
6 CWERSP1	Screw		
7 CWEKH200	Large Ergo Tig Handle		

# Gas Feed Hose	
Part Number	Description
CWGS4	Gas Supply Hose C/W 8.9mm Quick Fit

