

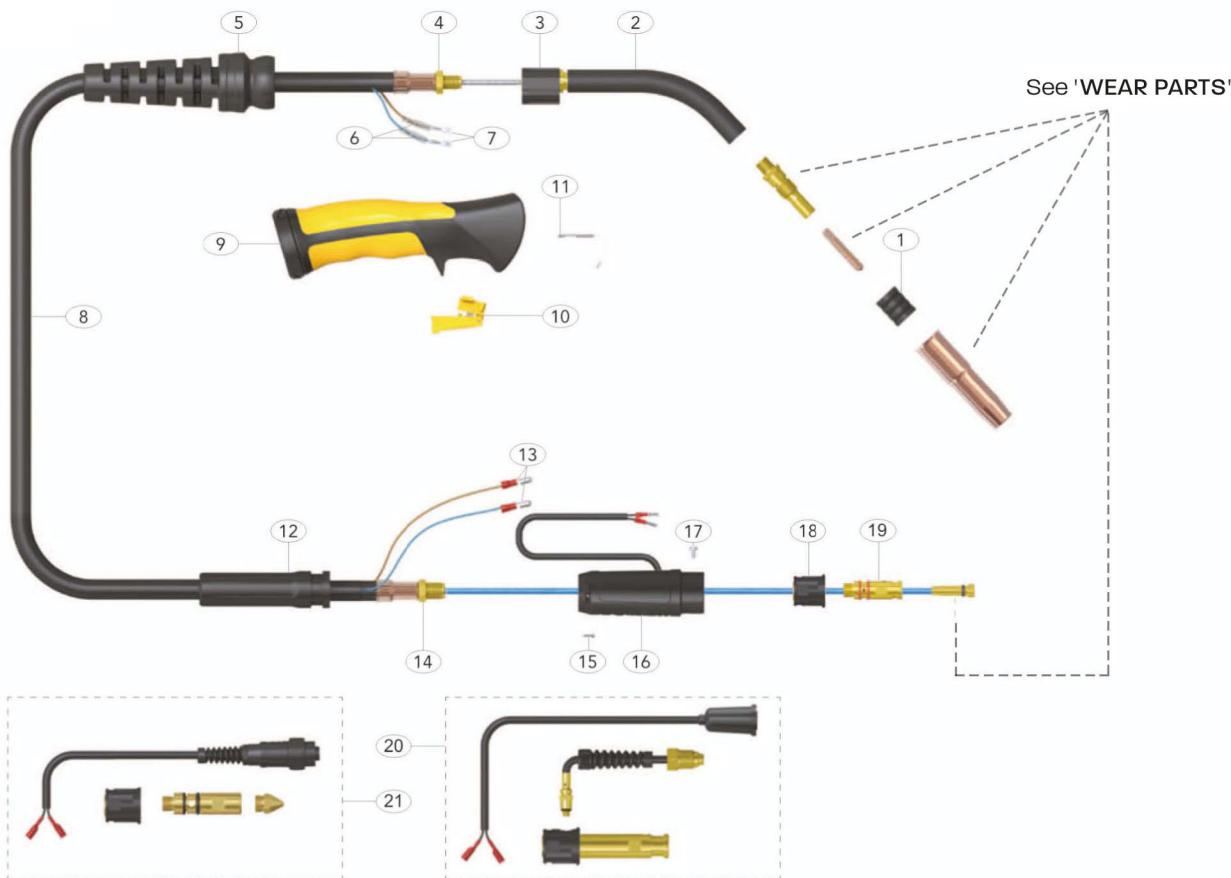

Rating: 230A CO<sub>2</sub>, 200A mixed gas, EN60974-7 @ 60% duty cycle. 0.8 to 1.2mm wires



Model	
Description	Part Number
Welding Torch c/w Miller Fitting	CWGPWTW200-10M
Welding Torch c/w Lincoln Fitting	CWGPWTW200-10L

Spare parts			
Part Number	Description	Part Number	Description
1	CW32 Adjustable Nozzle Insulator	14	CWXL1542 Cable End Lock Nut (M12 X 1.0)
2	CWLS-TW2 Swan Neck Assembly	15	CWSCSP1-1 Handle Screw
3	CWG1515 Ergo Handle Location Body	16	CWSC2578H/S Gun Plug Housing
4	CWB1505 Lock Nut	17	CWBL1541 Gun Plug Screw
5	CWG8015-BK Handle Cable Support C/W Ball Joint	18	CWECM1575/2 Hybrid Plug Body TWC 180-400
6	CWB1521-C Cable Terminal Cover	19	CWECET1575/1 Tweco 1-4 Power Pin
7	CWB1521 Cable Terminal	20	CWCEL1575K Lincoln Connector Kit Complete
8	CWSTH200-10E Cable Assembly X 10ft	21	CWCEM1575K Miller Connector Kit Complete
	CWSTH200-12E Cable Assembly X 12ft		
	CWSTH200-15E Cable Assembly X 15ft		
9	CWG2514-BK Handle and Lock Nut Assembly		
10	CWG2516 Medium/Large Ergo Trigger		
11	CWB2517 Hanger Hook (Optional Extra)		
12	CWC2841 Cable Support		
13	CWB1522 Cable Terminal Male		