

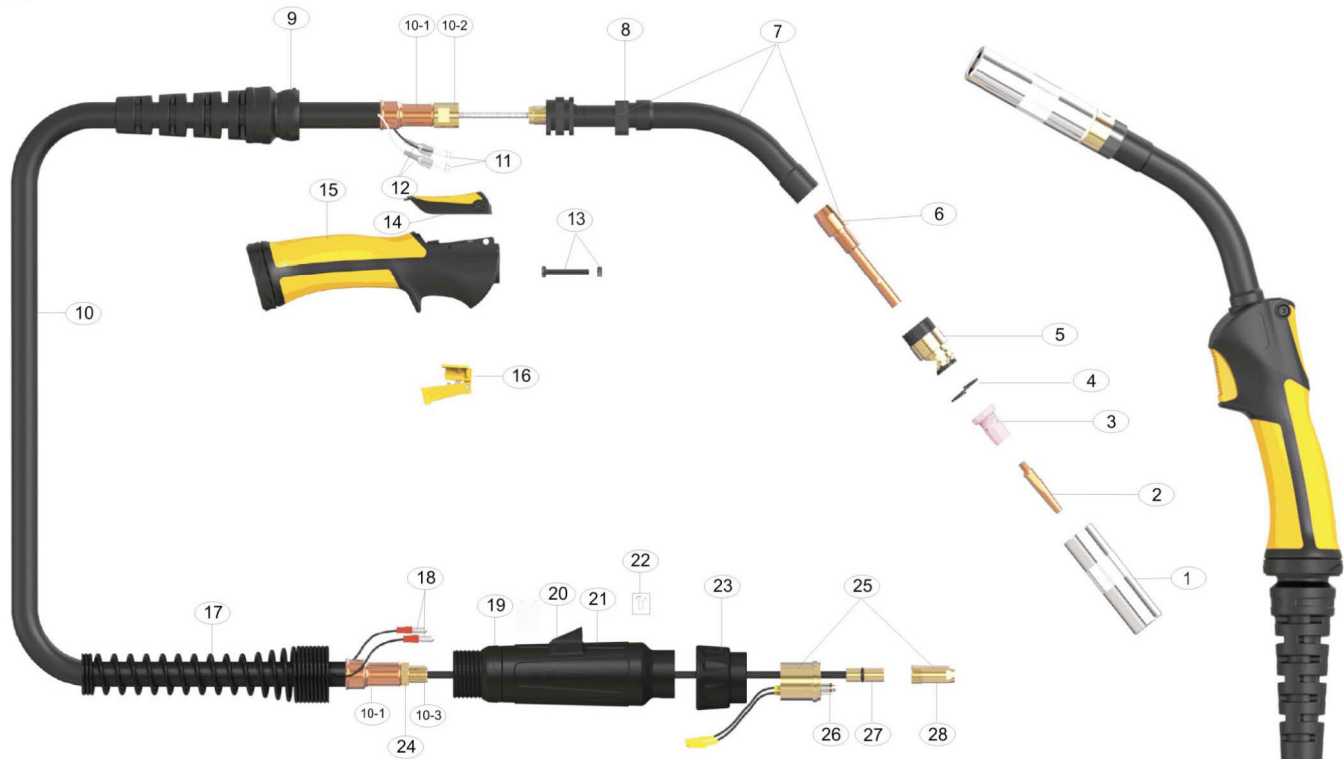

Rating: 500A Co<sub>2</sub> 350A Mixed Gas, @ 50% Duty Cycle



Model	Part Number
<b>Description</b>	<b>4M</b>
GPG PN500A MIG TORCH	CWGPGN500A-40ER

Spare Parts			
Part Number	Description	Part Number	Description
1	CWPA5029 Nozzle Cylindrical	15	CWXCELG2515-KJ Handle With Lock Nut
2	CWJ45-1.2 Contact Tip	16	CWGBH2516M-Y Trigger
3	CWPA5003 Gas Diffuser	17	CWC8026 Housing Spring
4	CWPA5004-W Nozzle Retaining Washer	18	CWB1522 Cable Terminal Male
5	CWPA5004 Insulator	19	CWT8028 Spring Cable Support Nut
6	CWPA5005N Tip Adaptor	20	CWSC8017 Large Housing Cover
7	CWLS-PN5001 Swan Neck Assembly	21	CWPT5022 Gun Plug Housing Assembly
8	CWLW1515 Handle Location Body	22	CWB1526 Gun Plug Screw
9	CWG8016-BK Handle Cable Support C/W Ball Joint	23	CWB1519/S Euro Housing Nut Assembly
10	CWSTH500-30E Cable Assembly × 3MT	24	CWXL1542 Cable End Lock Nut
	CWSTH500-40E Cable Assembly × 4MT	25	CWPE1122 Gun Plug Body C/W Spring Pins
	CWSTH500-50E Cable Assembly × 5MT	26	CWB1524 Gun Plug "O" Ring
10-1	CWLW35 Copper ferrule	27	CWPA3535-30 Steel Liner × 3MT 1.0-1.4mm
10-2	CWN14MM-M Cable End		CWPA3535-40 Steel Liner × 4MT 1.0-1.4mm
10-3	CW12MM Cable End		CWPA3535-50 Steel Liner × 5MT 1.0-1.4mm
11	CWB1521 Cable Terminal	28	CWPE1122-2 Liner Stem
12	CWB1521-C Cable Terminal Cover		
13	CWDMNS Screw Kit		
14	CWDM0-Y op Housing With Grip		

